

AA Portable Power Corp.

Title	Model	Description	Page
Product Specification	LM-AA2900A	Lithium/Iron Disulfide (Li/FeS2)	1
1. Preface			
The purpose of this product specification is to provide technical information for the Lithium/Iron Disulfide (Li/FeS2) Lithium battery LM-AA2900A, supplied by AA Portable Power Corp.			
2. Description and Model			
2.1 Description		Lithium/Iron Disulfide (Li/FeS2)	
2.2 Model		LM-AA2900A	
3. Specification			
3.1 Rated Capacity		2900mAh at 1000mA discharge	
3.2 Average Weight		14.5g	
3.3 Nominal Voltage		1.5V	
3.4 Work Voltage		1.30V at Constant current 200mA discharge	
3.5 Cut-off Discharge Voltage		0.80V	
3.6 Max.Discharge Current		2000mA	
3.7 Volume		8.0 cubic centimeters (0.5 cubic inch)	
3.8 Lithium Content		Less than 1 gram (0.04 oz.) per cell	
3.9 Ambient Temperature			
for Standard Charge		0℃~ 45℃	
for Discharge		-20℃~ 60℃	
3.10 Storage			
for within the temperature		-20℃~ 60℃	
for within the humidity		≤75%	
3.11 Energy Density			
Wh/L			
Wh/Kg			
3.12 Shell Life		10years	
3.13 Charge State Internal Impedance			
4.Appearance			
Appearance shall be free from any remarkable scratch,flaws, rust, discoloration or electrolyte leakage(visible or by smell)			
5.Standard Test condition			
5.1 Environment Conditions			
Unless otherwise specified,all test stated in this Product Specification are conducted within the temperature 15~25℃ and the humidity 45~85%RH.			

## AA Portable Power Corp.

Title	Model	Description	Page
Product Specification	LM-AA2900A	Lithium/Iron Disulfide (Li/FeS <sub>2</sub> )	2

### 5.2 Test Equipment

#### (1) Impedance meter

The impedance meter with AC 1kHz should be used

### 6. Test Procedure and Its Standard

Item	Measuring Procedure	Standard
6.1 Appearance	Visual	No Defect and Leak
6.2 Dimension	Caliper	As item 8
6.3 Weight	Scale	As item 3.12
6.4 Max. Discharge Current	Until final discharge voltage	2000mA
6.6 Open Circuit Voltage	measure open circuit voltage	>1.72V
6.7 Internal Impedance	Measure the battery with 1kHz AC	
6.8 Discharge Capacity	The battery discharge until final discharge voltage 0.8V, at 0.2C mA and measure the capacity	>2900mAh
6.9 Leakage Proof	After full charging, the battery shall be stored at $40 \pm 2^\circ\text{C}$ and humidity $80 \pm 5\%$ for 21 days	No leakage should be observed by visual inspection

### 8. Dimension (Bare cell) mm

### 7. Discharge Curve discharge at 1000mA to 0.8V

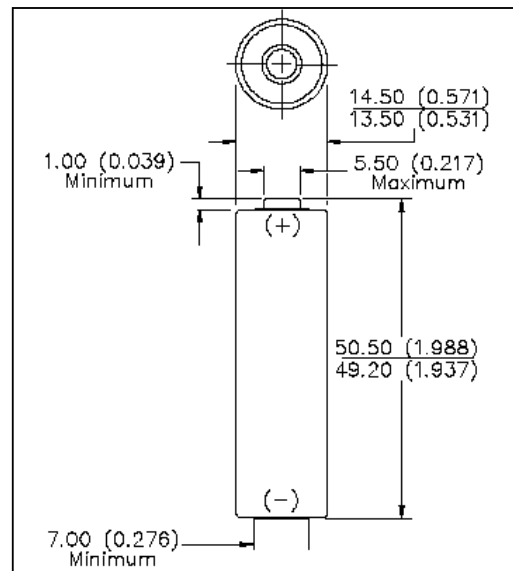
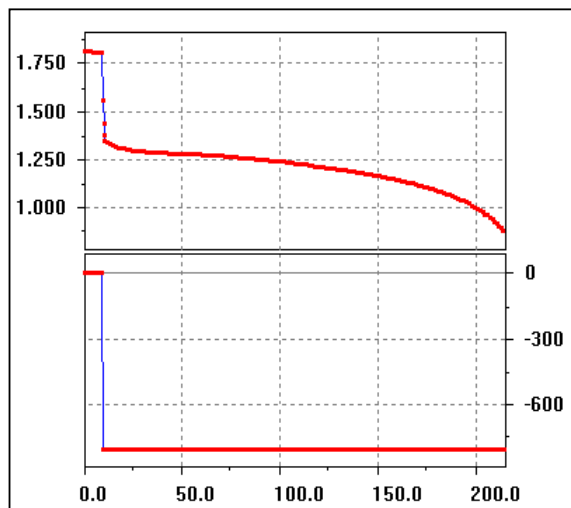

## LFB-Structure

