

LASER DIODE

SPECIFICATIONS FOR APPROVAL

Customer :

Model : L65P7S-D/E-L

Tentative

Signature of Approval

Approved by _____

Checked by _____

Issued by _____

Approval by Customer



LECC TECHNOLOGY CO.,LTD.
SHANGHAI LECC OPTO.CO.,LTD.

<http://www.lecc.com.tw>

[E-MAIL:sales@lecc.com.tw](mailto:sales@lecc.com.tw)

L65P7S-D/E-L

InGaAlP Laser Diode

Tentative

Ver. 1 May. 2006

◆ OVERVIEW

L65P7S-D/E-L is a MOCVD grown 660nm band *InGaAlP* laser diode with quantum well structure. It's an attractive light source, with a typical light output power of CW 120mW and pulse 350mW for optical storage devices such as DVD-R/-RW/+R/+RW/RAM.

◆ APPLICATION

- 16 X DVD-RW/+RW, DVD-RAM
- 16 X DVD-R/+R
- Portable High Density Optical Disc Drives

◆ FEATURES

- Visible Light Output : $\lambda_p = 660 \text{ nm}$
- Optical Power Output : 120mW CW, 350mW Pulse
- Package Type : TO-18 (5.6mm ϕ)

◆ ELECTRICAL CONNECTION

Bottom View

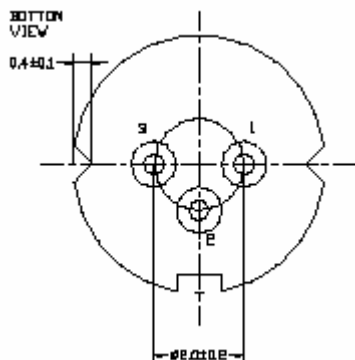

Pin Configuration

D	LD cathode, No PD (Fig. 1)
E	LD, anode, No PD (Fig. 2)

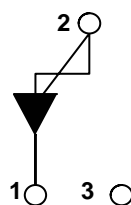

Fig. 1
L65O7SD

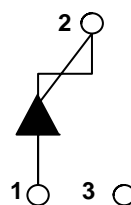

Fig. 2
L65O7SE



LECC TECHNOLOGY CO.,LTD.
SHANGHAI LECC OPTO.CO.,LTD.

<http://www.lecc.com.tw>

E-MAIL:sales@lecc.com.tw

Tentative

◆ **ABSOLUTE MAXIMUM RATING at Tc=25°C**

Items	Symbols	Values	Unit
Optical Output Power (CW)	Po	120	mW
Optical Output Power (Pulse, Tp≤10ns,Duty 33%)	Pp	350	mW
Laser Diode Reverse Voltage	V	2	V
Operating Temperature	Topr	-10 ~ +75	°C
Storage Temperature	Tstg	-40 ~ +80	°C

◆ **ELECTRICAL and OPTICAL CHARACTERISTICS at Tc=25°C**

Items	Symbols	Min.	Typ.	Max.	Unit	Condition
Threshold Current	Ith	-	75	100	mA	CW
Operating Current	Iop	-	200	220	mA	CW, Po=120mW
Operating Voltage	Vop	2.0	2.5	3.0	V	CW, Po=120mW
Peak Wavelength	λ_p	654	660	666	nm	CW, Po=120mW
Slope Efficiency	SE(η_d)	0.7	1.0	1.3	W/A	CW, Po=120mW
Beam Divergence ³⁾	$\theta_{ }$	7	9	12	°	CW, Po=120mW
	θ_{\perp}	15	18	21	°	CW, Po=120mW
Beam Angle	$\Delta\theta_{ }$	-	-	±3	°	CW, Po=120mW
	$\Delta\theta_{\perp}$	-	-	±3	°	CW, Po=120mW
Polarization Angle	PA					
Polarization Ratio	PR					

NOTICE : L65P7S-D/E-L to be operated on APC

The above product specifications are subject to change without notice.



LECC TECHNOLOGY CO.,LTD.
SHANGHAI LECC OPTO.CO.,LTD.

<http://www.lecc.com.tw>

E-MAIL:sales@lecc.com.tw

◆ PACKAGE DIMENSION

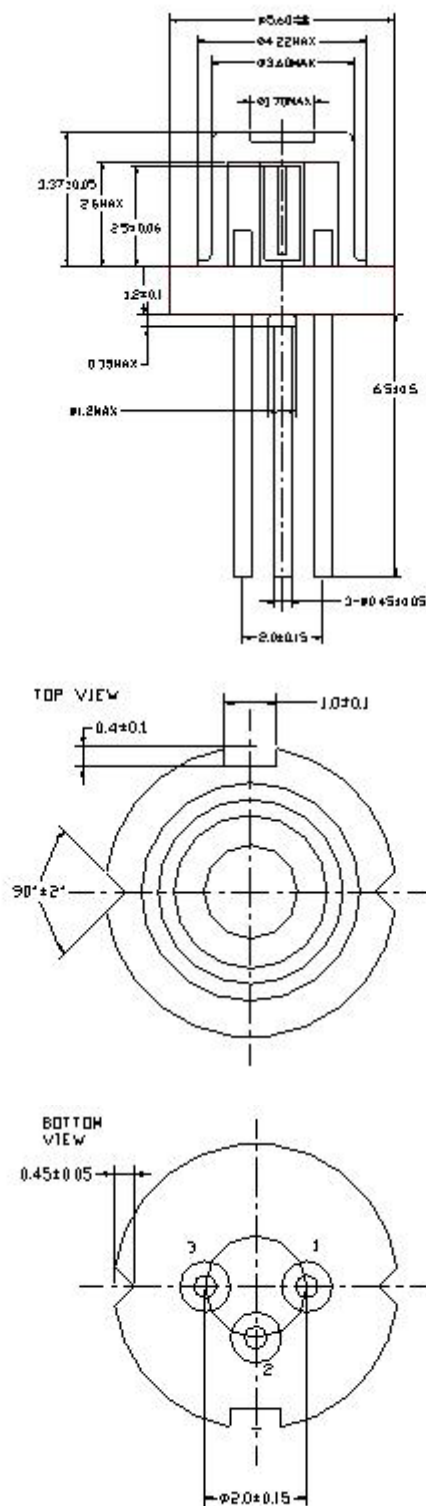

LECC TECHNOLOGY CO.,LTD.
SHANGHAI LECC OPTO.CO.,LTD.

<http://www.lecc.com.tw>

E-MAIL:sales@lecc.com.tw